

# PRODUCT DOCUMENTATION

**d line**  
ERUD HÖLACHER DESIGN

**Product Name:** Wall door stop Ø20x31 mm

**Article Number:** 14.5055.02.001

*Satin stainless steel*

16.5055.01.001

*Polished stainless steel*

## Photo:



## Drawing:

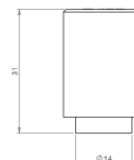

## Product Information:

Material: AISI 316 stainless steel  
Surface finish: Satin 320 grain or polished  
Height: 20 mm      Width: 20 mm      Depth: 31 mm

## Product Specification:

d line wall door stop Ø20x31 mm produced in AISI 316 satin or polished stainless steel.

d line products are always produced in the highest quality stainless steel AISI 316. d line is a simple and functional design, but the minimalistic exterior hides advanced technic that ensures the hardware's strength and durability for many years.

Certificate: EN 179, EN 1906

Warranty: 20 years (non-mechanical/-electronic parts)

## Spare Parts/Accessories:

-

## Related Products:

14.5050.02.009      Wall door stop Ø14x21 mm

## Mounting:

See instruction supplied with the product

## Packing:

1 piece in a bag.

## Maintenance:

Wash down with mild detergent, rinse off with clean water, and dry off with soft dry cloth. Please do not use scouring powders, steel wool or aggressive cleaning products as these may damage the surface. If spots appear on the surface it is not due to the stainless steel, but to impurities in the environment or the use of aggressive cleaning agents.

## Environment:

No environmental risk and no risk of fire.